

# x2VOL.com Student Login

**PLEASE SEE PLUS PORTALS FOR FULL  
INSTRUCTIONS AND MISS MEDOFF IN ROOM  
201A WITH ANY QUESTIONS**

x2VOL

powered by  intelliVOL

# First Time Login: [www.x2VOL.com](http://www.x2VOL.com)

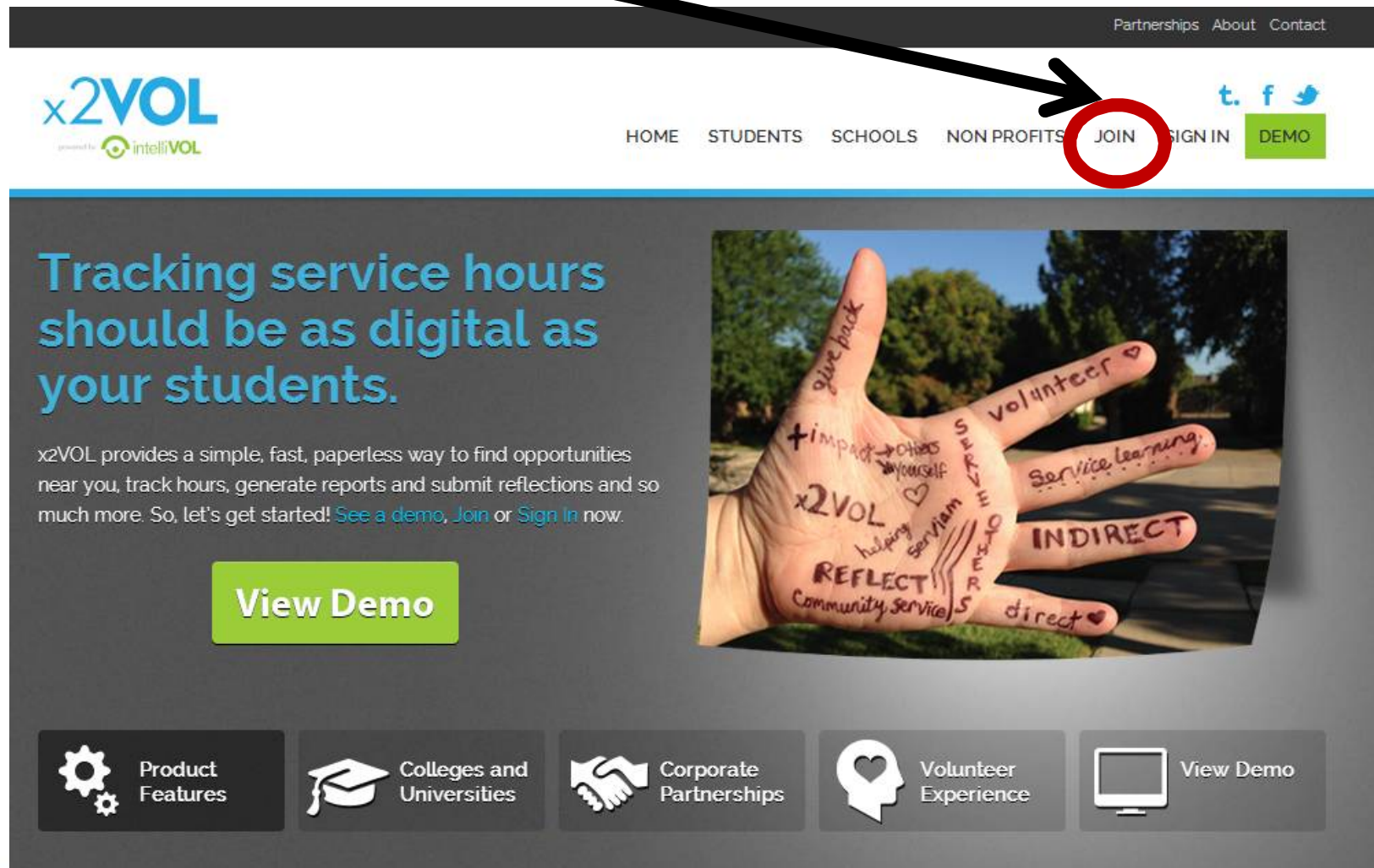

Partnerships About Contact

**x2VOL**  
powered by **intelliVOL**

HOME STUDENTS SCHOOLS NON PROFITS **JOIN** SIGN IN DEMO

t. f

## Tracking service hours should be as digital as your students.

x2VOL provides a simple, fast, paperless way to find opportunities near you, track hours, generate reports and submit reflections and so much more. So, let's get started! [See a demo](#), [Join](#) or [Sign in](#) now.

[View Demo](#)

**Product Features** **Colleges and Universities** **Corporate Partnerships** **Volunteer Experience** **View Demo**

give back  
+ impact → others  
→ yourself  
x2VOL  
helping  
service  
REFLECT!  
Community Service  
volunteer  
service learning  
INDIRECT  
direct

# Complete Your Registration

## 1. Search for your School

### Volunteer Registration



#### Find Your School

Enter your school's name or city to begin searching for your school.

## 2. Enter your Last name and Student ID (use ID where it says email address)



#### Find Your School

Enter your school's name or city to begin searching for your school.

No Logo	Sacramento Charter High School 2315 34th St Sacramento, 95817 <a href="#">Change School</a>
---------	--

#### Account Lookup

Check to see if your school has begun the registration process for you.

Last Name

Identifier

Search

# Complete Your Profile

## Student Registration

- 1 Basic Info
- 2 Interests
- 3 Settings

### Basic Information

#### Name

#### Org Identifier

#### Month/Year of Birth

#### Gender

 Male  Female

### Contact Information

#### Address

### Profile Picture

 No file chosen

#### Mobile Phone

#### Home Phone



# Set Password and Select Class Group

## Student Registration

- 1 Basic Info
- 2 Interests
- 3 Settings

### Sign-In Preference

#### Email Address (Username)

KatyMiller@mailinator.com

#### Create Account Password

New Password

Confirm New Password



### School Group

Schools use groups to deliver messages as well as target students in different classes or organizations. Choose one of the mandatory groups.

#### School

No Logo Sacramento Charter High School  
2315 34th St  
Sacramento, 95817

#### Mandatory Group:(Select One)

- Class of 2014
- Class of 2015
- Class of 2016
- Class of 2017



# Join New Groups and Add Goals

The screenshot displays the x2VOL web application interface. At the top, there is a navigation bar with the following items: Dashboard, Opportunities & Projects, **Groups & Goals** (circled in red), Profile, Help, and Logout. Below this is a secondary menu with three items: My Groups & Goals (Joined & Pending Groups and Goals), Group/Goal Search (Find a Group or a Goal), and Incentive Messages (Incentive Messages). The main content area is titled "My Groups & Goals" and features the x2VOL logo (powered by IntelliVOL) and a green "Add New Group" button (circled in red). Below the main content, there is a dropdown menu for "Class of 2018" and two buttons: "Change Group" and "Add Goal". At the bottom, there is a table with the following headers: GOAL NAME, PROGRESS, START, and END.

GOAL NAME	PROGRESS	START	END
-----------	----------	-------	-----







# Find Volunteer Opportunities

## Find Opportunities



Community Opportunity Search [Modify Search](#)

Search Results: 4

	OPPORTUNITY	PROFILE MATCH	
School Sponsored	 <b>Spartan High School Meals-On-Wheels</b> <i>Multiple Events</i> Deliver hot meals to families in the community. <a href="#">There is 1 additional opportunity for this organization</a>	64.00 % 	<a href="#">View Event Details (1)</a>
School Sponsored	 <b>Spartan High School After School Tutoring</b> 01/01/2014 - 05/28/2014 After school tutoring in the library every Tuesday afternoon from 3-4 for students who need help with math, science, history, or english.	35.50 % 	<a href="#">Add to My Opportunities</a>
	 <b>Dallas Public Library Help shelving books</b> 02/09/2014 - 12/31/2014 Every Tuesday and Thursday from 4-6 PM help us shelve books at	16.00 % 	<a href="#">Add to My Opportunities</a>

# Log Your Service Hours

1. Add a Personal Project

2. Add Hrs to a Recurring Project

3. Add hours for an activity that you signed up for through x2VOL

OPPORTUNITY	CLAIMED HOURS	VERIFIED HOURS	APPROVED HOURS	RESUBMIT
<input checked="" type="checkbox"/> <b>Fun Run 5K</b> 01/04/2014 I helped pass out waters at the Fun Run 5 K	1.00		1.00	✘
<input checked="" type="checkbox"/> <b>Mowing Lawn</b> 01/04/2014	1.50	1.50	1.50	✘



## Create a Personal Project



# Creating a Personal Project

### Activity

### Personal Projects

If you've completed an event or activity that's listed in x2VOL, such as at a local hospital, then claim your hours as a Personal Project.

### Interests

- Humanitarianism
  - Government
  - Faith-based
  - Educational
- ### Career Clusters
- Agricultural & Natural Resources
  - Government & Public Administration
  - Manufacturing
  - Human Services
  - Business & Administration
  - Transportation, Distribution & Logistics
  - Education & Training
  - Architecture & Constructions
  - Scientific Research/Engineering
  - Marketing, Sales & Service
  - Information Technology

### Make this a recurring project

Allows you to reuse this personal project for future claims without reentering the information. (ex. Volunteering at the food bank several times a month.)

### Activity Contact

### Verification

The contact specified here will be used for verification request through email.

### Claim Hours

Date:   
Hours:   
Minutes:

### Reflections

(Please include a reflection about your service to the community and the impact that you made.)

### Apply Hours to Goal(s)

Select where the hours being claimed will be credited to. Either choose an [Exclusive Goal](#) or choose the option "Apply to all Non-Exclusive Goals".

*NOTE: Below are all ACTIVE goals in your organization.*

*If you are logging hours that do not belong in an active goal below, choose "Apply to all Non-Exclusive Goals" and the hours will appear in your activity log for the date you submitted.*

	GOAL NAME	GROUP	START	END	GOAL	MET	REMAIN
<input checked="" type="radio"/>	Apply to all Non-Exclusive Goals:						
	Junior Service Hours	Class of 2015	6/1/2013	6/1/2014	50.00	43.25	7.42
	President Award Hours	Class of 2015	6/1/2010	5/31/2015	100.00	163.25	0

The hours that I am submitting are accurate and the details (including hours, dates, location and contact information) are truthful. I understand that the information I am submitting may be audited for accuracy.  
None

### Comments

DATE	USER	COMMENT

### Claim History

DATE/TIME	EVENT	USER

Apply your Hours to a Goal

# Print Your Service History

## History



Total Hours Approved: **181.42** Total Hours Claimed: 186.42 Total Hours Verified: 44.67 Total Hours Denied: 2.00 Total Hours Pending: 0.00

### Filter Results

Type:  Select All  Personal Project  Community Opportunity  School Sponsored  
Status:  Select All  Submitted  Verified  Denied  Approved  
Start Date:  End Date:

Filter Results



Search Results: 32

Newest to Oldest

Hours Submitted: 189.25 Verified: 46.00 Denied: 3.50 Approved: 184.75

Type Personal Project: 22 Community Opportunities: 3 School Sponsored: 7

Print Results

Export to PDF

OPPORTUNITY	TYPE	CLAIMED HOURS	VERIFIED HOURS	APPROVED HOURS	CREATED	MODIFIED
<input checked="" type="checkbox"/> Sundae Social 01/05/2014 Serving ice cream at a social event at a retire ...	Personal Project	3.00	3.00	3.00	01/06/2014	01/06/2014
<input checked="" type="checkbox"/> Junior Year Hours 01/01/2013 This is a bulk entry of all my hours I did juni ...	Personal Project	100.00	-	100.00	01/06/2014	01/06/2014

# See Snapshot of your x2VOL Account on your Dashboard

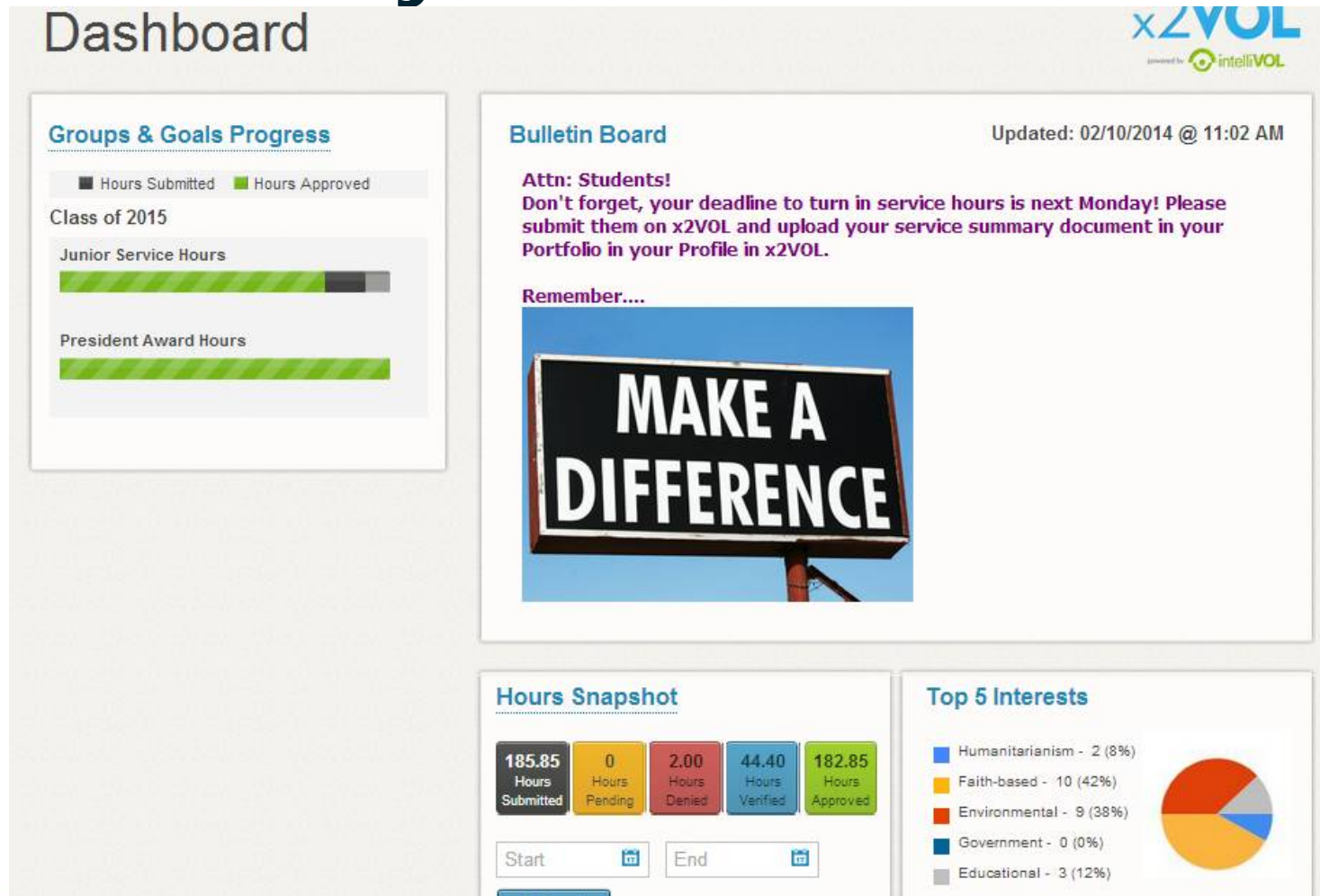

# Try the x2VOL Free Mobile App!



After you register and login on the web site – try our mobile app to log your hours!

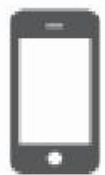

Available on the  
**App Store**



Available in  
**Android Market**



# Mobile App Screens

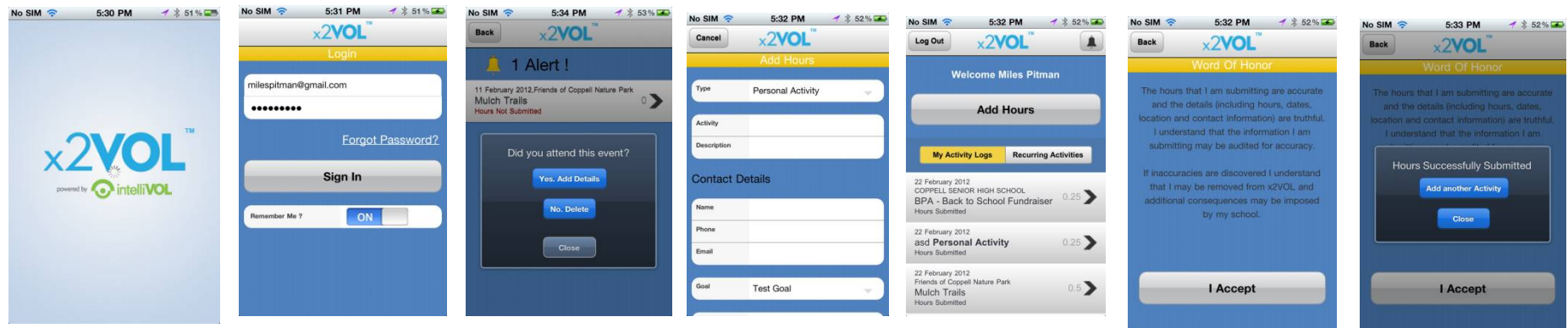

**Note: You must login at least once on the web site** before you can use the free x2VOL mobile app. The app is for logging hours only.

# Remember

- You can find opportunities and sign up for activities through x2VOL.
- If you can't login – contact [support@intelliVOL.com](mailto:support@intelliVOL.com).
- If you have any feedback, questions or technical problems, click the NEED HELP? link at the top of the page.
- THANK YOU for using x2VOL where we believe Every Hour Counts!